

**PRESSURE PLATE**  
(MOVABLE)  
SECTION A-A

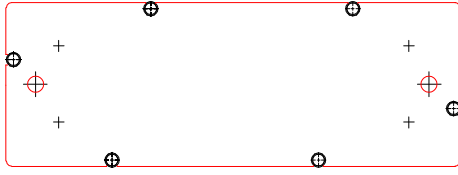

**FRAME PLATE**  
(FIXED)

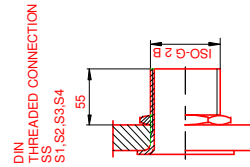
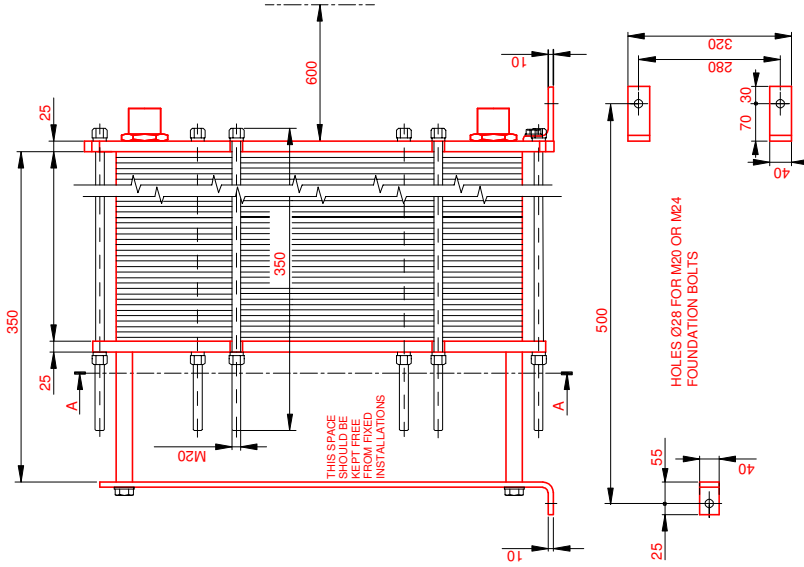
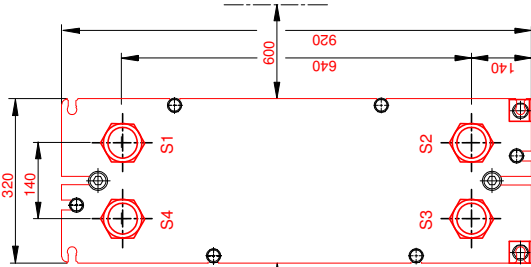

REMARKS:	SIDE 1	SIDE 2	GASKET	NBRB CLIP-ON
TEST PRESSURE	13 bar	13 bar	PLATE MATERIAL	ALLOY 316
DESIGN PRESSURE	10 bar	10 bar	PLATE THICKNESS	0.50 mm
MAX TEMPERATURE	100 °C	100 °C		
MIN TEMPERATURE	0 °C	0 °C		
WEIGHT WITH WATER	160 kg		HEAT LOAD	900 kW

TOTAL LENGTH	555
TOTAL WIDTH	320
TOTAL HEIGHT	920

Do not use this drawing for foundation bolting or piping layout.

ALL DIMENSIONS IN MILLIMETERS

SIDE	MEDIA	F.D.G.	INLET	TEMP.	OUTLET	TEMP.	FLOW RATE	PRESSURE DROP
1	Water		S1	80.0 °C	S2	60.0 °C	39.9 m³/h	54.95 kPa
2	Water		S3	10.0 °C	S4	60.0 °C	15.5 m³/h	9.801 kPa

SUPPLIER	REF.	ITEM NO.
		900 KW 80/60-10/60 SCP new
AGENT / REF.		
CUSTOMER NAME / REF. NO.		
SIGN.	RISK CATEGORY	
	N/A	

PLATE HEAT EXCHANGER

**M6-MFG**  
ALS



bsea fise de scos  
DATE 2012-11-02  
REV NO. 0